



PREMIER
COMMERCIAL
PROPERTIES

FOR LEASE



INDUSTRIAL FOR LEASE

19960 St. Francis Blvd
Nowthen, MN 55303

AVAILABLE SPACE

- 10,136 Total Sq. Ft.
- 1,456 Sq. Ft. front office
- 8,680 Sq. Ft Warehouse / Shop
- 6 – 14' x 14' Drive in doors (Drive-thru)
- 2 – 12' tall x 14' wide drive-in doors (Drive-thru)
- In floor heat throughout
- Wash bay with drains
- CO-2 Detection and Exhaust Ventilation
- Past usage allowed for outside storage with Permit
- Fenced Lot with Class 5 Gravel

LEASE RATES:
Negotiable

FOR MORE INFORMATION, CONTACT

Richard Lee

612-718-9919

richlee@premiercommercialproperties.com



PREMIER
COMMERCIAL
PROPERTIES

FOR LEASE

CONTACT: Richard Lee

MOBILE: 612-718-9919

EMAIL: richlee@premiercommercialproperties.com

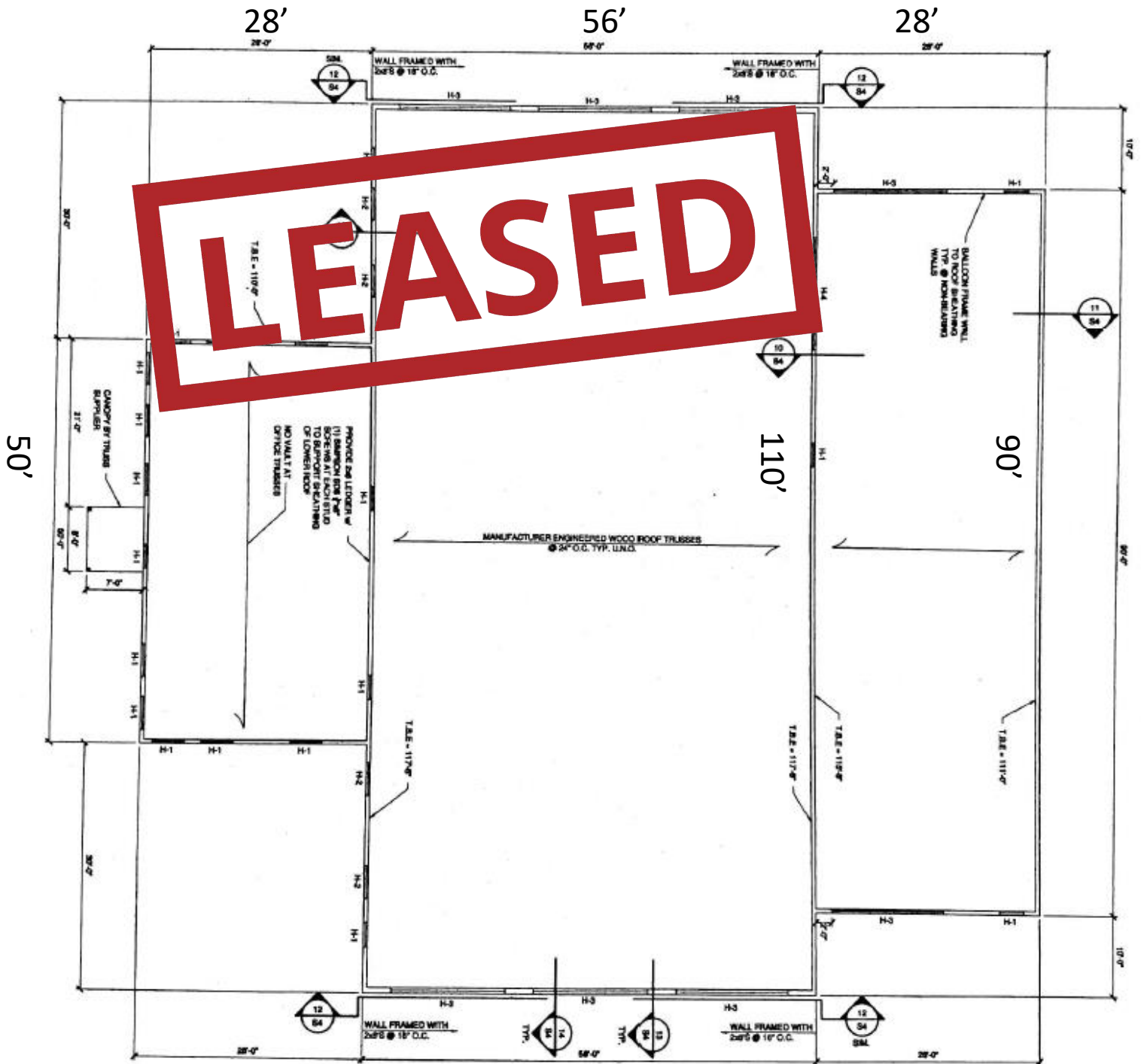



PREMIER
COMMERCIAL
PROPERTIES

FOR LEASE

CONTACT: Richard Lee

MOBILE: 612-718-9919

EMAIL: richlee@premiercommercialproperties.com



LEASED





PREMIER
COMMERCIAL
PROPERTIES

FOR LEASE

CONTACT: Richard Lee

MOBILE: 612-718-9919

EMAIL: richlee@premiercommercialproperties.com

